

FITTING INSTRUCTIONS

KTM RC390

120-014-155-005



IMPORTANT NOTES

KEY



NOTE!



CAUTION!



WARNING!



The front forks are a very important part of the motorcycle and will affect the safety and stability.



Read the instructions carefully and make sure you understand them before you proceed. If you have any queries please contact your dealer or nearest supplier of K-Tech Suspension immediately.



K-Tech Suspension Ltd. cannot be held responsible for any damage to vehicle, front fork, personal injury or property if the installation instructions are not followed exactly.



Please read this instruction manual before installing the cartridge kit.



This cartridge kit should only be installed by an authorised K-Tech Dealer.

- 1** This cartridge kit was designed and developed for a specific motorcycle model and should only be installed onto the recommended model in its original condition.

- 2** After this product has been installed you should take a low speed test ride to check stability of the vehicle has been maintained.

- 3** This product needs specialised tools to fit correctly and should only be fitted by a K-Tech dealer or a person with the correct tools and qualified in motorcycle suspension and trained to install the front fork cartridge kits to ensure the performance of this product.

- 4** When Fitting the kit, fit only one leg at a time to avoid confusion. Always fit the compression cartridge into the left hand leg and the rebound into the right.

- 5** Remove the front forks from the motorcycle using the manufacturer's workshop manual.



SECTION B

1

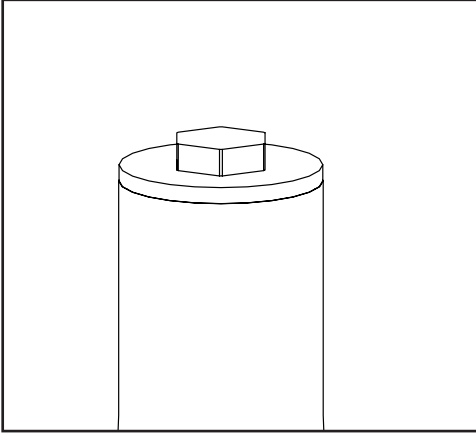

Undo the standard top cap from the outer tube using a 22mm spanner.

2

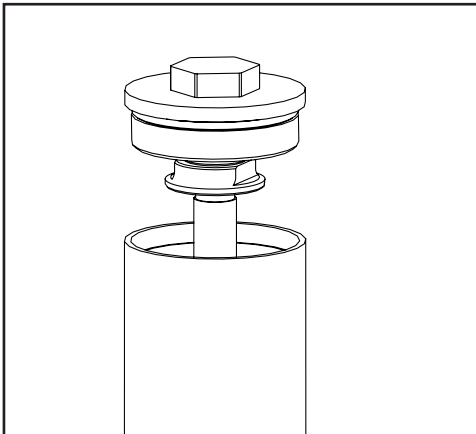

Using a 22mm and a 19mm spanner remove the top cap by loosening the lock nut. The top cap and the lock nut can then be removed.

3

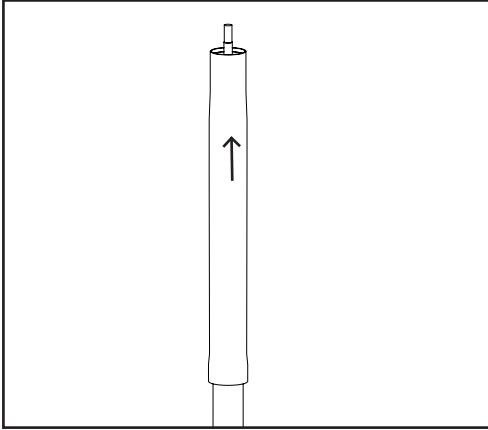

With the top cap and lock nut removed the outer tube can now be taken off giving access to the top of the inner tube.

4

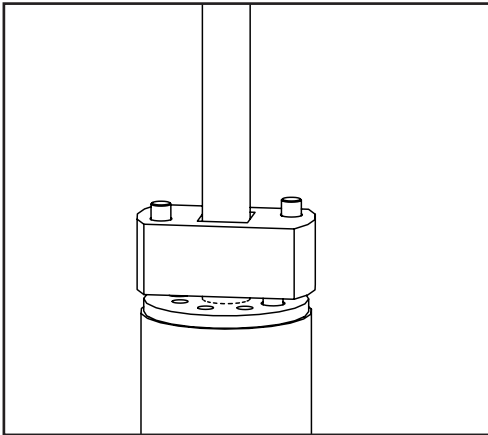

Using tool 213-211-210 and a 24mm spanner the seal head can be removed from the top of the inner tube.

SECTION B

5

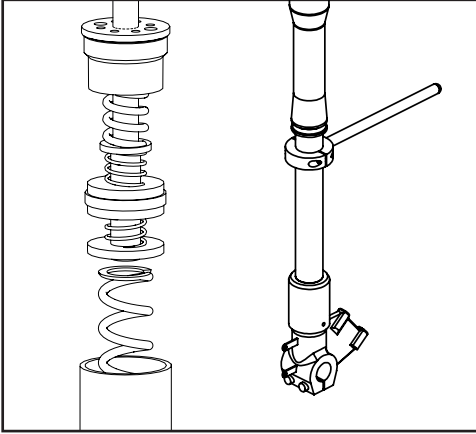

With the internal seal head removed the standard piston rod assembly and spring can be removed. The inner tube also needs to be removed from the foot using tool 113-200-000.

You are now ready to fit the K-Tech cartridge.

6

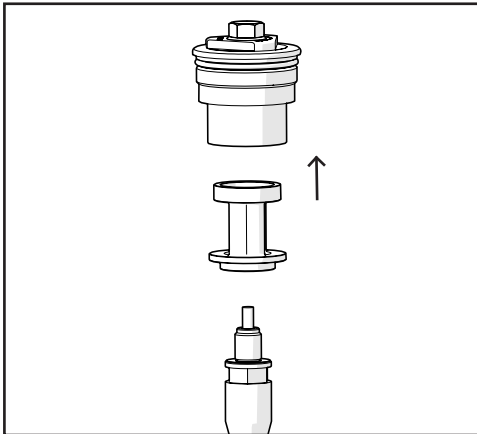

Remove the top cap assembly and the nylon preload pusher from the K-Tech cartridge.

6

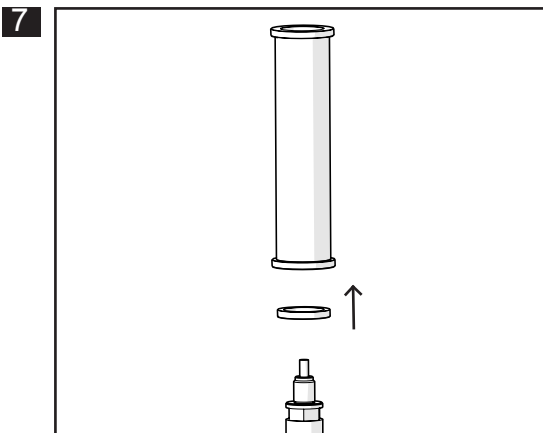

Remove the preload tube and spacers from the piston rod assembly.

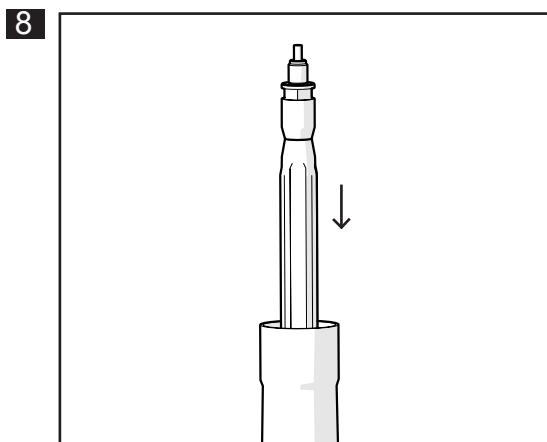

Lower the cartridge into the empty fork leg.



Fit the compression (black) cartridge into the left hand leg.



Fit the rebound (natural) cartridge into the right hand leg.

9

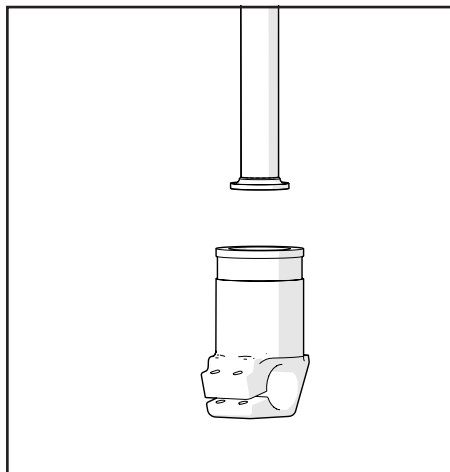

Fit cartridge into the foot and re-install in the inner tube using tool no. 113-200-000 and torque to 140Nm.

10

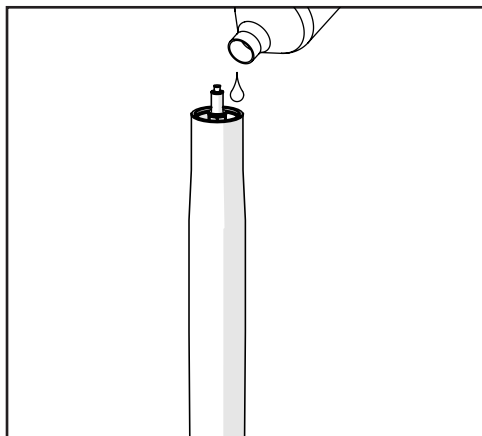

K-Tech recommend 5wt.



Before filling the fork with oil make sure the spring seat washer is installed onto the cartridge.

11

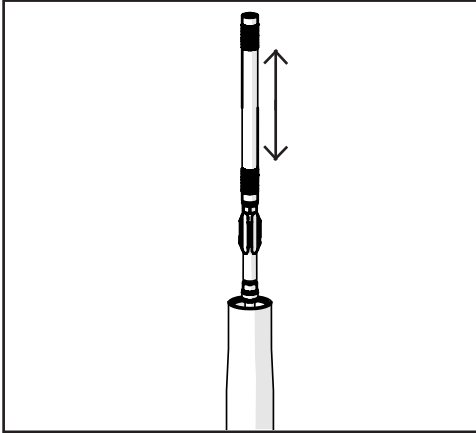

Make sure the oil always covers the top of the damper tube assembly.

Pump the piston rod up and down using tool No. 113-030-005. Pump the rod up and down approximately 20 times until it feels smooth with no air bubbles in the oil.

12

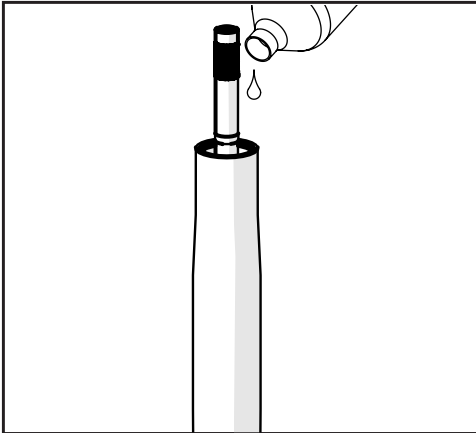

Completely fill the fork leg with oil.

13

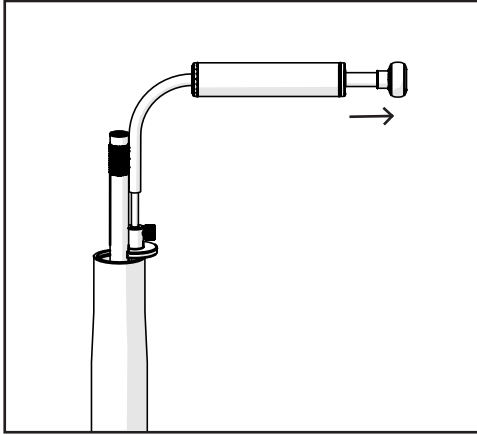

When setting oil level make sure the piston rod is fully down.

Set your oil level using tool No. 113-030-500. Set your tool to 145mm and suck the excess oil out.

14

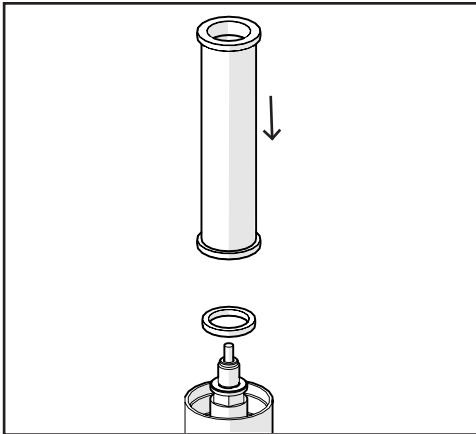

Install the preload tube and spacers onto the cartridge.

15

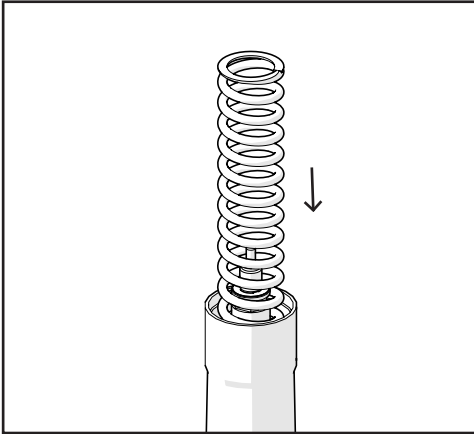

Install the spring you have chosen.



It is advised to use K-Tech springs as these are a smaller diameter and give a smoother action to the fork.

16

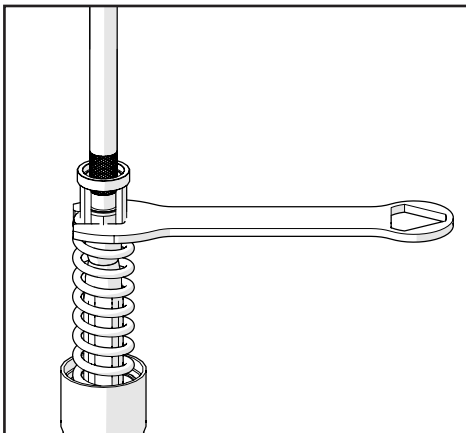

Install the nylon preload pusher. Using tool no. 113-030-005 pull up the piston rod and hold it in place with tool no. 113-010-020.

SECTION B

17

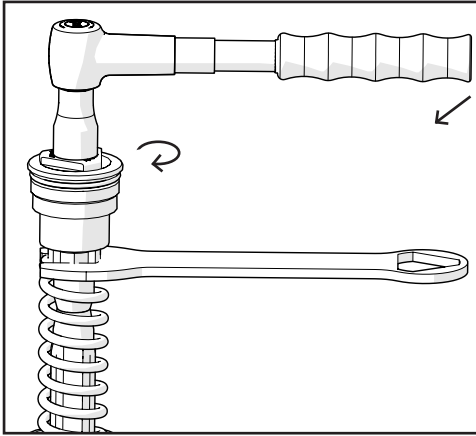

Install top cap and torque to 15Nm using a 14mm socket.

18

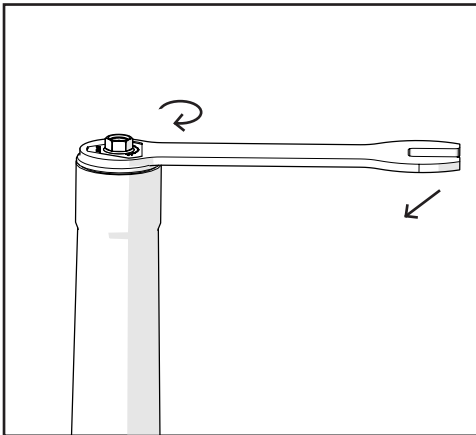

Screw the outer tube up onto the top cap using tool no. 113-010-020.

19

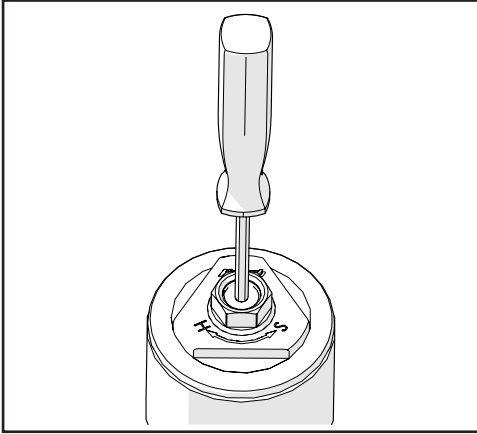

Set your preload using a 14mm socket by winding the 14mm hex in the centre of the top cap. All adjustments are made from fully out (anti-clockwise) 1 turn is equal to 1mm of preload.

Set your adjuster clicks by winding your adjuster needle out to the recommended setting using a 3mm allen key. Reference the recommended settings in this manual.

- 20 Reinstall the fork onto the motorcycle in accordance with the manufacturers workshop manual.

RECOMMENDED SETTINGS

| | |
|------------------|----------------------|
| Cartridge stroke | 130.00mm |
| Cartridge length | 682mm |
| Compression: | 16 Clicks |
| Rebound: | 18 Clicks |
| Air gap: | 150mm |
| Spring rate: | 36-260-XXX |
| Fork position: | Set to owners manual |



www.ktechsuspension.com

Contact your local K-Tech dealer for more details at
www.ktechsuspension.com/service-centres-and-partners